

**Compact Size (16 mm diameter, 12 mm seated length)  
High Gain, Fast Time Response**

**FEATURES**

- Compact and Light Weight
- Metal Package (TO-8 Type)
- High Cathode Sensitivity
- High Gain .....  $2 \times 10^6$  (Typ.)

**APPLICATIONS**

- Spectroscopy
- Biotechnology
- Radiation Measurement
- Bacteria Monitor



Figure 1: Typical Spectral Response

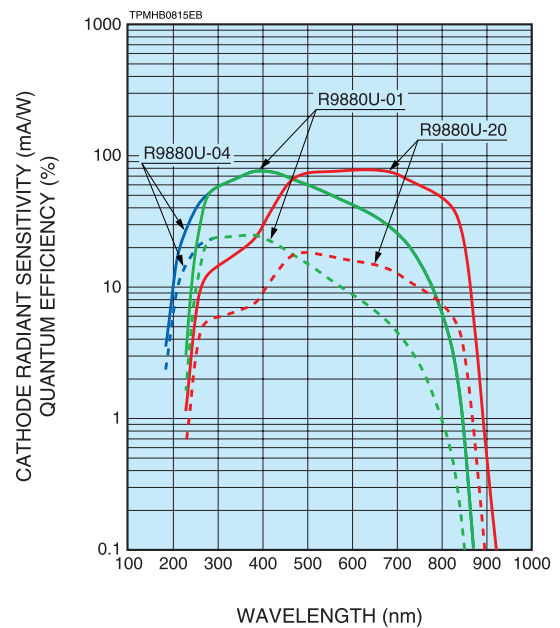
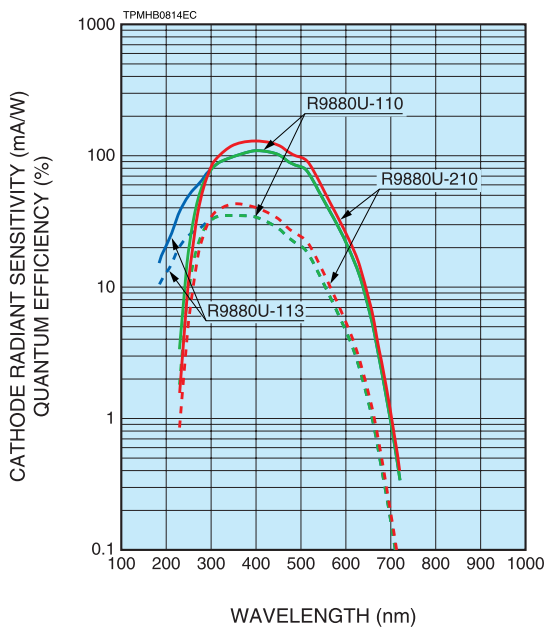

Subject to local technical requirements and regulations, availability of products included in this promotional material may vary. Please consult with our sales office. Information furnished by HAMAMATSU is believed to be reliable. However, no responsibility is assumed for possible inaccuracies or omissions. Specifications are subject to change without notice. No patent rights are granted to any of the circuits described herein. ©2014 Hamamatsu Photonics K.K.

# PHOTOMULTIPLIER TUBE R9880U SERIES

Type No.	Spectral Response		Photo-cathode Material <sup>(A)</sup>	Window Material <sup>(B)</sup>	Dynode Structure / Stages <sup>(C)</sup>	Maximum Ratings		Cathode Characteristics				
	Range (nm)	Peak Wavelength (nm)				Supply Voltage Between Anode and Cathode (V)	Average Anode Output Current in Total (mA)	Luminous		Blue Sensitivity Index (CS 5-58) Typ.	Red/White Ratio (R-68) Typ.	Radiant <sup>(D)</sup>
								Min. ( $\mu\text{A/lm}$ )	Typ. ( $\mu\text{A/lm}$ )			
R9880U-01	230 to 870	400	MA	K	MC/10	1100	0.1	100	200	—	0.2	77
R9880U-04	185 to 870	400	MA	U				100	200	—	0.2	77
R9880U-20	230 to 920	630	MA	K				350	500	—	0.45	78
R9880U-110	230 to 700	400	SBA	K				80	105	13.5	—	110
R9880U-113	185 to 700	400	SBA	U				80	105	13.5	—	110
R9880U-210	230 to 700	400	UBA	K				100	135	15.5	—	130

**NOTE:** (A) MA: Multialkali, SBA: Super bialkali, UBA: Ultra bialkali  
 (B) K: Borosilicate glass, U: UV glass  
 (C) MC: Metal channel  
 (D) Measured at peak wavelength

Figure 2: Typical Gain

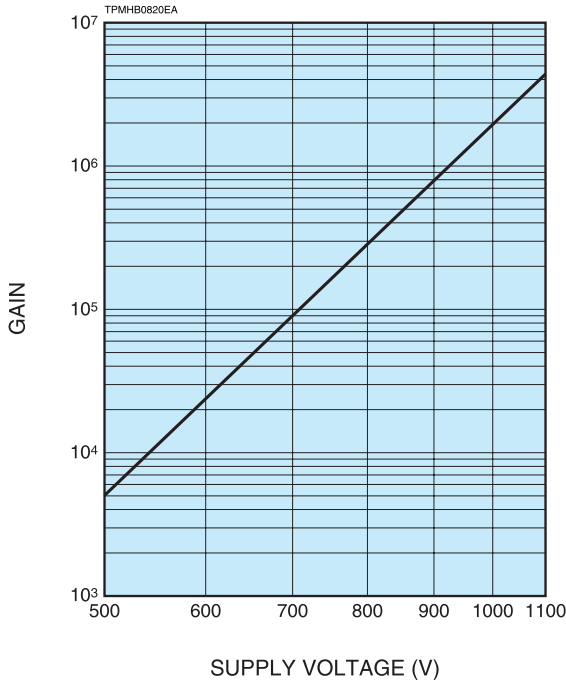
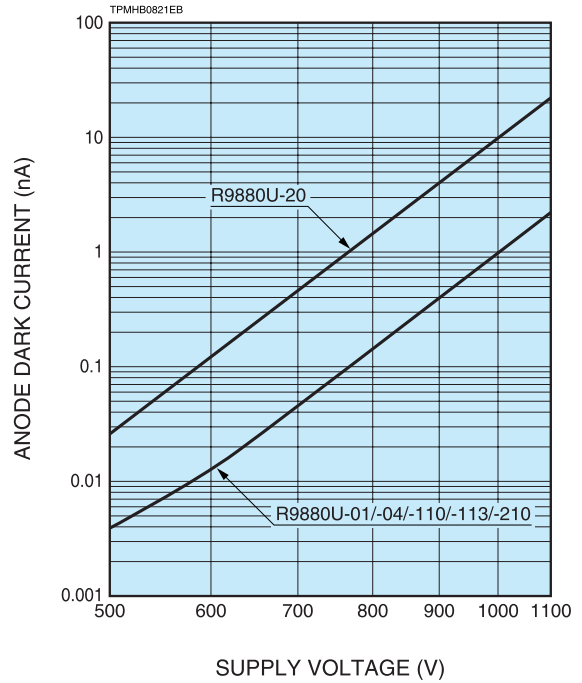

Figure 3: Anode Dark Current (v.s. Supply Voltage)



Anode to Cathode Supply Voltage (V)	Anode Characteristics								Operating Ambient Temperature (°C)	Storage Temperature (°C)	Type No.
	Luminous		Gain Typ.	Dark Current (After 30 min)		Time Response					
	Min. (A/lm)	Typ. (A/lm)		Typ. (nA)	Max. (nA)	Rise Time Typ. (ns)	Transit Time Typ. (ns)	TTS Typ. (ns)			
1000	100	400	2.0 × 10 <sup>6</sup>	1	10	0.57	2.7	0.2	-80 to +50	-80 to +50	R9880U-01
	100	400		1	10						R9880U-04
	350	1000		10	100						R9880U-20
	80	210		1	10						R9880U-110
	80	210		1	10						R9880U-113
	100	270		1	10						R9880U-210

### VOLTAGE DISTRIBUTION RATIO AND SUPPLY VOLTAGE

Electrodes	K	Dy1	Dy2	Dy3	Dy4	Dy5	Dy6	Dy7	Dy8	Dy9	Dy10	P
Distribution Ratio	1	1	1	1	1	1	1	1	1	1	1	0.5

Supply Voltage: 1000 V, K: Cathode, Dy: Dynode, P: Anode

Figure 4: Dimensional Outline and Basing Diagram (Unit: mm)

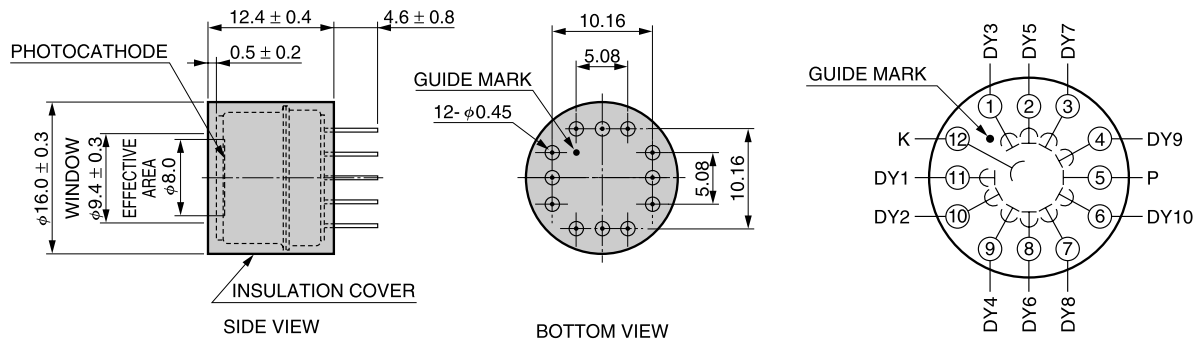

TPMHA0539EC

### [ACCESSORIES] (Unit: mm) **SOLD SEPARATELY**

#### ● Socket E678-12-01

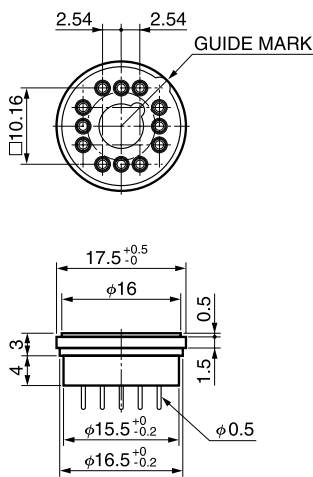

TACCA0304EA

#### ● D Type Socket Assembly E10679-02

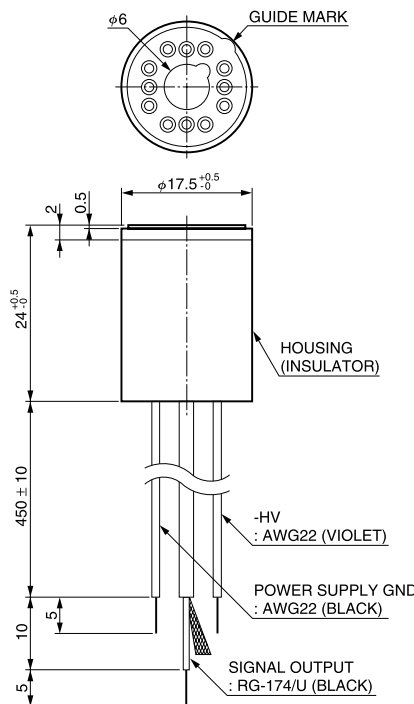

\* SHV / BNC connector type (E10679-03) and pin type (E10679-51) are also available.

TACCA0299EC

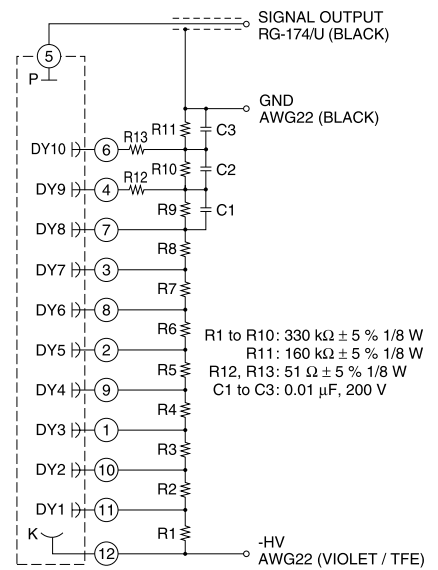

MAXIMUM HIGH VOLTAGE = -1100 V  
DIVIDER CURRENT = 318 μA

TACCO0165EA